

# RFP SKATE PARK 11-2018



**SUBMITTED BY:**

## Pillar Design Studios, LLC

PILLAR DESIGN STUDIOS, LLC

1960 W. HAWK CT.

CHANDLER, AZ 85226

888.880.5112

CONTACT PERSON

NICOLE LICARI ROBERTSON

DIRECT 312.257.6088 OR [NICOLE@PILLARDESIGNSTUDIOS.COM](mailto:NICOLE@PILLARDESIGNSTUDIOS.COM)

# TABLE OF CONTENTS

#1 PROPOSAL FORM

#2 LOCAL REFERENCES

#3 STATEMENT OF QUALIFICATIONS

Tony Hawk attending the Historic Fourth Ward Skatepark grand opening in Atlanta, GA. Recipient of a \$25,000 Tony Hawk Foundation Grant.



November 19, 2018

City Clerk's Office  
City Hall  
401 N. 5<sup>th</sup> Avenue  
Laurel, MS 39440

RFP – City of Laurel Skate Park

Dear Mayor and City Council,

We thank you for the opportunity to submit on your Skatepark project. We are the only Skater owned and operated Action Sports Development Design Firm, who specialize in the design bid build process. We have successfully worked with all of the leading Skatepark construction companies in the industry and have an in-depth knowledge of Skatepark construction cost. We have a perfect record in regards to project bidding and budgeting and offer intimate understanding in terms of bringing qualified builders to the table.

Our past experience working with municipalities during this initial phase allows us to smoothly guide you through this process, while discussing opportunities and restrictions. From concept to completion, we are known for minimizing cost while maximizing skate-ability. We commend the City in realizing the need for a Skatepark and see this as an opportunity to raise the standard for Skatepark design and create something unlike another facility to date.

Our team is comprised of Brad Siedlecki, Landscape Architect (Project Manager - Avid Skater – Lead Designer), Barrett Crook, Professional Engineer (Structural Review, Technical Advisor), Bradley Bartell, RLA, (Senior Landscape Architect, Quality Control), Scott Matthews, Design Production (Mechanical Drafting, Skater), and Nicole Licari Robertson, Business Administration (Fundraising, Finance). We have collectively worked on over 300 Skateparks across the United States and the World, including design bid build projects, many with budgetary restrictions.

We are familiar with your Skatepark and realize an initial design has been completed with users input. We welcome the opportunity to use this initial concept as a base of our design, ultimately using the requested elements while upgrading the design to maximize flow and skate-ability whilst ensuring the project will have multiply bidders all within the \$150,000 budget provided. We hope our proposal highlights our experience with cost management and value engineering, we have included project examples that we feel best depict our experience in these areas.

Our team of dedicated professionals are here to walk you through the entire process, offering you more than an end product. We provide a service, refined process and a team of dedicated Skate professionals to help realize your goals. If you have any questions regarding our proposal or for contract negotiations, please contact Nicole Licari Robertson at 312.257.6088 or [Nicole@pillardesignstudios.com](mailto:Nicole@pillardesignstudios.com). We again thank you for the opportunity to submit and look forward to speaking with you.

Sincerely,



Pillar Design Studios, LLC  
e) [brad@pillardesignstudios.com](mailto:brad@pillardesignstudios.com), p) 480.285.6787



# #1 PROPOSAL FORM





**DESIGN PROPOSAL FORM**  
**CITY OF LAUREL SKATE PARK**

Note: Once completed, place this form (or an exact duplicate thereof) at front of Proposal

DATE: 11.14.2018

TO: **CITY CLERK'S OFFICE, CITY HALL**  
**501 N. 5<sup>TH</sup> AVENUE**  
**LAUREL, MISSISSIPPI 39440**

1. Submittal of this Proposal shall be taken as prima facie evidence that the CONSULTANT has full knowledge of the scope, nature, quality, and quantity of the Work to be performed, and the detailed requirements and conditions under which the Work is to be performed.
2. The undersigned CONSULTANT proposes and agrees, if this Proposal is accepted, to enter into a Design Contract with the City of Laurel to perform and furnish all Work as indicated in the REQUEST FOR PROPOSAL, not to exceed 8% of the total project cost.
3. **PROPOSED TIMELINE FOR PROJECT:**  
Advertise for Request For Proposal – October 18, 2018  
Deadline for Proposals – November 19, 2018  
Evaluation of Proposals by Staff/Committee – 2 weeks  
Approval of Consulting Contract – Undetermined, but estimated to be 30 days

**Insert below the anticipated time required from Owner's acceptance of pervious phase.**

Schematic Design Submittal - 45 CALENDAR DAYS  
*(Insert number of Calendar Days anticipated between approval of Design Contract and submittal of Schematic Design)*

Schematic Design Review – Allow 1 week

4. In submitting this proposal, it is understood that the right is reserved by the City of Laurel to accept or reject any or all Proposals and to waive any informalities.

5. The names of all persons interested in the foregoing Proposal as principals are: (IMPORTANT NOTICE: If Consultant is a corporation or limited liability company, give legal name of corporation, state where incorporated, and names of president and secretary; if a partnership, give name of all individual co-partners composing the firm; if Consultant is an individual, give first and last name in full.)

SIGNED BY:



Brad Siedlecki, Principal

---

NAME OF CONSULTANT:

Pillar Design Studios, LLC

---

ADDRESS:

1960 W. Hawk Ct.

---

CITY AND STATE:

Chandler, AZ 85286

---

TELEPHONE NO.:

888.880.5112 or direct, 480.285.6787

---



## #2 LOCAL PROJECT REFERENCES

### VICKSBURG SKATEPARK – VICKSBURG, MS

A project much like the Laurel Skatepark project. Pillar was hired by the City of Vicksburg to handle Design, Planning, Construction Documentation and Post Design Services for the Vicksburg Skatepark. Our team handled the bid process and construction administration services. The entire park was built above ground and designed to fit within an existing park system and has a ¼ mile asphalt walking path.

Project Size: 8,000 sq. ft.  
Project Budget: \$171,000

#### Client Information:

Marcia Weaver, Special Project Dir  
1401 Walnut St., Vicksburg, MS 39180  
601.634.4509  
[marciaw@vicksburg.org](mailto:marciaw@vicksburg.org)

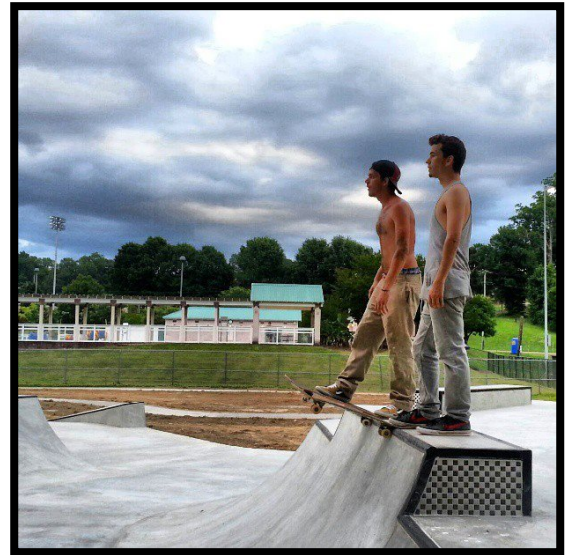

The Skatepark was completed on-time and within budget, using the design bid build method. Pillar handling bidding services and on-site construction administration.



## PLEASANTON SKATEPARK

The City of Pleasanton was approached by a Community Advocate and a dedicated group of Skaters about the need for a Skatepark in their community. When a new masterplan project came about the City decided it was time to make the dreams of these individuals come true. The Pleasanton Skatepark design was completed with multiple design input meetings. The local users requested a well-rounded design that has a little something for everyone. Working within the given budget provided by the Client, our design team produced this phased design. Please note sections in blue are add alternatives if funding becomes available or in-kind donations are able to be secured.

Pillar served as Prime and Lead on the project handling all aspects of project management and development, including cost estimation, design and construction documentation. Our in house Engineer stamped the final drawings. Construction is set to begin in the New Year.

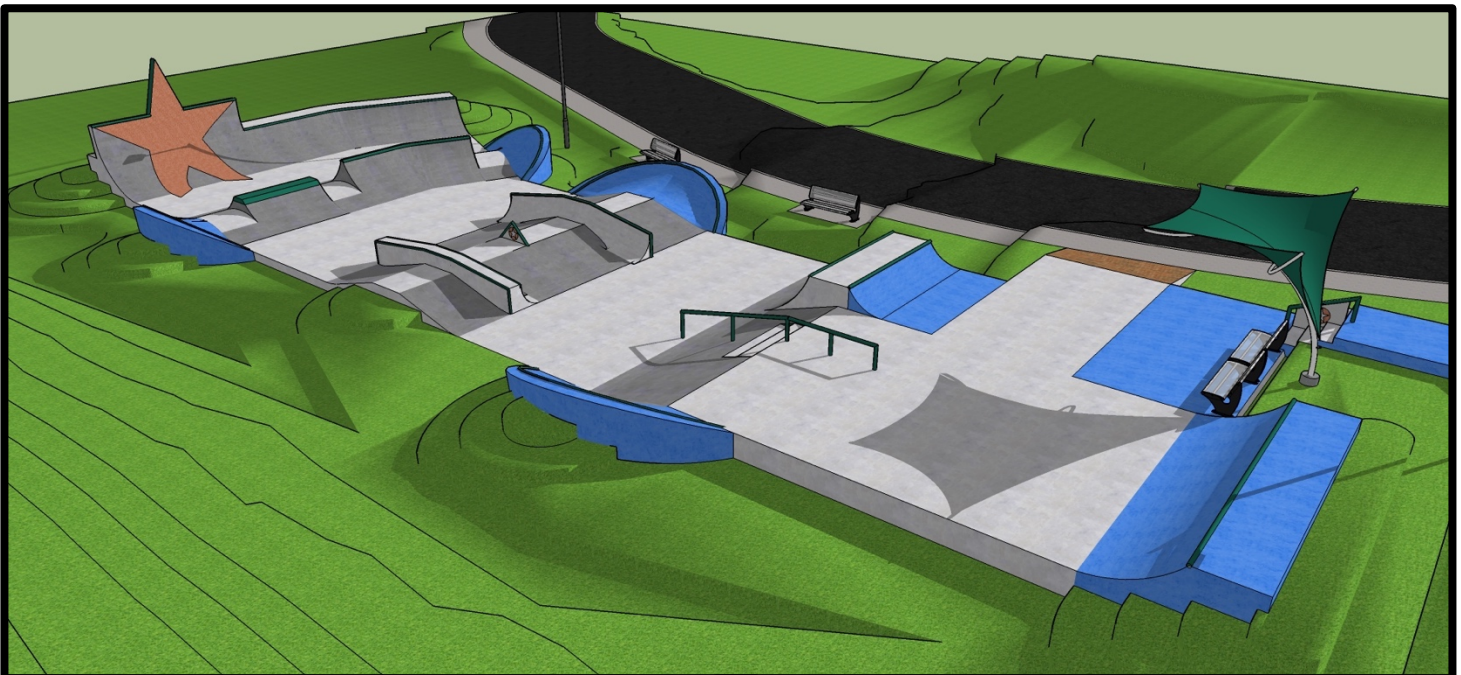

**Pleasanton Skatepark  
Public Design Input Meeting**

Join us for the design presentation,  
question / answer session and give us YOUR feedback!

**August 9th  
7:00pm - 9:00pm**





**Civic Center  
115 N Main St  
Pleasanton, TX 78064**

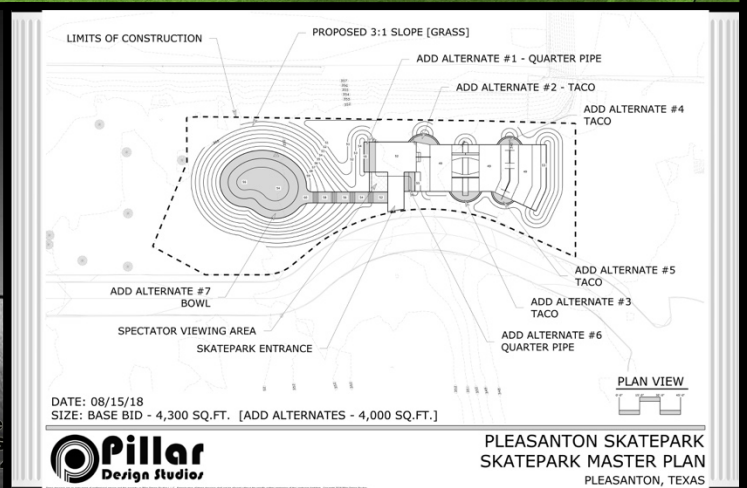

Client Information:  
Greg Leach, Parks and Recreation Facility Director  
City of Pleasanton  
108 Second St., Pleasanton, TX 78064  
830.569.3155, [gleach@pleasantontx.gov](mailto:gleach@pleasantontx.gov)

Project Size: 7,000 sq. ft.  
Estimated Cost: \$175,000



## PEARSALL SKATEPARK

The recipient of the Texas Recreation and Parks Society, Parks Design Excellence award, Pearsall Park is 505 acres. Designed to offer a dynamic open space with fitness and recreational amenities ideal for facilitating health, wellness and outdoor family gatherings. The site itself is unique as it was a former landfill, making this once unused plot a land, a very desirable family and community meeting place. Due to its location in this family recreational park, it was important to design the Skatepark to match the overall flow of the other amenities at Pearsall Park. Pillar handled all aspects of design including public input meetings, conceptual drawings, cost estimation, construction documentation and bidding assistance.

The park includes:

### Family Fun Zone

- Two (2) splash pads
- Two (2) basketball courts
- Twenty (20) picnic tables
- Two (2) shade canopies equipped with picnic tables
- Two hundred and fifteen parking spaces
- One (1) 40'x80' event pavilion area

### Skatepark

- Largest Skatepark offered in the City

### Event Stage

### Children's Playground

### Park Restroom

### Reinforced lawn area

Project Size: 13,000 sq. ft.

Estimated Cost: \$300,000

Actual Cost: \$295,000

### Contact Information:

Lead Landscape Architect

Larry Clark, ASLA

Bender Wells Clark Design

830 N. Alamo St.

San Antonio, TX 78215

210.692.9221

[lcark@bwcdesign.com](mailto:lcark@bwcdesign.com)

### City Contact:

J. Mark Wittlinger, Project Manager

City of San Antonio

210.207.2874

[Mark.Wittlinger@sanantonio.gov](mailto:Mark.Wittlinger@sanantonio.gov)









## # 3 STATEMENT OF QUALIFICATIONS

As a specialty Skatepark Firm we continually work all over the United States and the World, from our years of experience we have developed and cultivated the best approach for a project such as this.

### WHO WE ARE AND WHAT WE DO

Passionate  
Creative  
Dedicated

**Pillar Design Studios, LLC (Pillar)** is an Action Sports Development firm that specializes in Skatepark planning, construction, and process services. Founded in 2006 in Tempe, Arizona - Pillar is owned and operated by action sports enthusiast and avid skateboarder, Brad Siedlecki.

Pillar Skatepark Design Team:

Brad Siedlecki, Project Manager / Lead Designer  
Barrett Crook, Professional Engineer / Technical Advisor  
Bradley Bartell, Landscape Architect / Quality Control  
Scott Matthews, Production / AUTOCAD  
Nicole Licari Robertson, Administration/ Funding Assistance

### EXPERTS THAT THINK OUT OF THE BOX

*They are creative, professional and understand how to communicate with volunteers, experienced skaters and the community to facilitate a skatepark project.*

*Katie Churchill, MDI Skate Chair, MDI Skatepark located in Bar Harbor, ME*

#### // Vision

To create custom, high-quality Skateparks that truly adhere to the needs of your community, culture, and value. The idea is to create an aesthetically pleasing park that all community members can enjoy

#### // Mission

To design and construct quality Skateparks regardless of available space or proposed budget. From concept to completion, planning through construction -- our dedicated, professional staff work hard to ensure success for your Skatepark.

#### // Objectives

To create facilities that offer distinctive site-specific designs, which are sensitive to both the client's wants and the user's needs.. We understand that many factors determine a successful park - and just like any planning process, time must be put forth during the initial development process in order for it to be evident in the final product.

## MEMBERSHIPS AND AFFILIATIONS

Our Design staff is not only familiar with Skatepark standards and regulations; Mr. Siedlecki was one of the people responsible for many of these standards. After 17 years in the Skatepark industry, designing and creating construction documents he has created a comprehensive package that has become the industry standard. We are knowledgeable of ACI, ASTM and CSI formats. As well as follow ASTM: F2334 and F2480 standards.

We are an International  
Action Sports  
Development firm. All  
design, planning and  
construction  
documentation will be  
handled out of the main  
office of Pillar, located in  
Arizona.

Action Sports Environmental Coalition  
American Society of Civil Engineers  
American Society of Landscape Architects (ASLA)  
American Society for Testing & Materials (ASTM)  
American Concrete Institute (ACI)  
American Shotcrete Association (ASA)  
Concrete Specifications Institute (CSI)  
Council of Landscape Architects Registration Board (CLARB)  
Nation Recreation & Park Association (NRPA)  
United States Green Building Council (USGBC)

Certified Skatepark Designers by:  
The Tony Hawk Foundation  
Skaters for Public Skatepark  
Skate Park Association International formally Skate Park  
Association USA

Mr. Crook will be responsible for stamping the final construction documentation package. He is a registered Professional Engineer in the 23 states, including Mississippi and believes in continue education.

**Mississippi, PE License # 18348**





## SPECIALIZED EXPERIENCE

- Masterplan services including, but not limited to site selection and analysis, feasibility, cost estimating, phasing of design and assisting with grant submissions-funding.
- Well-rounded designs, incorporating texture, color and high-quality materials. Open communication, our team holds a strong emphasis on community input, with tools that draw and engage the local community.
- All team members have numerous years of experience working together within the roles listed, as well as decades of experience in the Skate industry and their specialized profession, i.e. Engineer, Landscape Architect, Skatepark Construction.
- Strong track record when it comes to delivering projects on-time and within budget. All design team members have worked in the field during construction to ensure a well-rounded approach and understanding of all aspects of the Skatepark process.



Pillar is a U.S. small business formed and dedicated to create custom, world class destination Skateparks. Over the past twelve years we have continued to grow while maintaining the core principles of our businesses.

- We have a 100% record for completing projects on-time and within budget
- We have never been dismissed from a job, nor been unable to meet the deadline or budget provide by a Client
- Zero occurrences of E&O insurance being used
- We have never filed bankruptcies, defaulted on a loan, changed ownership or company name

We have no pending litigation on any projects and have always fulfilled our contractual obligations.

# OUR APPROACH

As Skatepark specialist we travel all over the World creating custom one of a kind Skateparks along the way. We would like to provide the City of Laurel with a Skatepark unlike any other, we would like to offer diversity and a different approach. What makes our team stand out from the rest is our dedicated staff members and our process. We have little to no turnover within our team because we believe and love what we do. This is evident in our dedication, perseverance and creativity that we show each and every Skatepark project.



The objective is to create facilities that offer distinctive site-specific designs, which are sensitive to both the client's wants and the user's needs. The idea is to create an aesthetically pleasing park that all community members can enjoy.

## Key Skatepark Design Factors

- ✓ **Designs that consider all ages, styles and abilities**
- ✓ **Overall fit within the park complex; integration, accessibility and aesthetics**
- ✓ **Site Specific Designs – Creating a Skatepark that best uses the site given**
- ✓ **Structural and Safety Standards, GREEN Methods, ADA Compliant**
- ✓ **Quality over Quantity, Designers consider flow, traffic patterns and various users**
- ✓ **Creating a recreational space for all community members**
- ✓ **Incorporating the local heritage, color and artistic elements**

Our past experience in the planning stage, master planning and value engineering provides valuable knowledge and affords a streamlined process that ensures an efficient and accurate budgeting. We are so much more than a wholesaler of Skateparks that offer options out of a catalog. Our team embraces all types of action sports actives and we believe each park should be unique, promote creativity and are versatile enough to include all community members.



## PROJECT UNDERSTANDING

Our goal is to aid the City of Laurel in creating and completing a custom, concrete Skatepark that fits within the given budget of \$150,000. We understand the budget is allocated from Grant funding and are capable of meeting the Aug. 31, 2019 completion date. Our team will review all applicable studies and the work that has been completed on the Skatepark project to date. We will revise the current Skatepark design to enhance flow while staying within the budget. We will use our industry contacts, leadership and accurate cost estimation process to ensure multiple bidders within the estimated budget, during the bidding process.

We are more than familiar with value engineering and cost estimating and can guarantee construction bids to come in on budget— not only is your Project Manager a veteran in the Skate Industry, he is also a Landscape Architect with hands on Skatepark construction experience. He brings a fresh approach to Skatepark design with an efficient and effective process. We just recently completed the design bid build process in Framingham, MA and Dubuque, IA both came in on or under budget.

We will work with the City and your community to ensure the new Skatepark located at Daphne Park is a complete success.



Responsible for the first GREEN Skatepark, Our Marsh Creek Skatepark located in Raleigh, NC was completed in 2009 and included recycled granite, rain gardens and environmentally sound construction means and methods.



## SKATEPARK MEANS AND METHODS

We believe a successful Skatepark is more than just flow and skate-ability. Our design team takes into consideration the community, the given site and the history of the local area. We are extremely knowledge-able when it comes to public Skatepark cost and will provide a true and accurate cost estimate. We understand some design input has been gathered and a preliminary design has been created, we are happy to review these documents and work with all stakeholders to form the final design that meets budgetary requirements. We have completed numerous Skatepark projects similar to this – including in Waynesville, NC where the original designer was let go due to not being able to meet budgetary restrictions. We believe our clients accurately describe our abilities and success, we welcome you to reach out to any of the references provided.

In Framingham, MA we worked with the Community, Skatepark Advisory board and the City to create this 10,000 sq. ft. Skatepark that fit the needs and the request of the local skateboarders. Our team began with site analysis and feasibility services which involved numerous site visits and public and private input meetings and resulted in site assessment, selection of the site, placement and appropriate size. In order to circumvent the additional water from the Skatepark facility, we designed a raingarden drainage system, as well as updated the current drainage system within the park. This was a design-bid-build project, where Mr. Siedlecki worked closely with the City to ensure the bid was packaged to draw qualified builders to the project. Part of our design process included an in-depth construction estimate, using local numbers and including pre-vailing wage, ensuring bids stay within the approved budget. The end result is this state of the art, 10,000 sq. ft. Skatepark facility that came in on time and budget.





## DIVERSE FUNCTIONAL DESIGNS

Instead of focusing on specific styles (street or transition), we focus our energy in designing a well-rounded skatepark that allows for ALL types of users and abilities while incorporating both consistent flow and progression. Our experienced design staff thrives on visually pleasing parks that the entire community can enjoy. We create integrated commonplaces with varied options for the needs of a diverse community, which brings people together. In Rodanthe, NC at the Rodanthe Skatepark we included a large vertical flat wall that doubles as an outdoor movie screen. In Phoenix, AZ the open plaza style Skatepark doubles as a venue for community events.

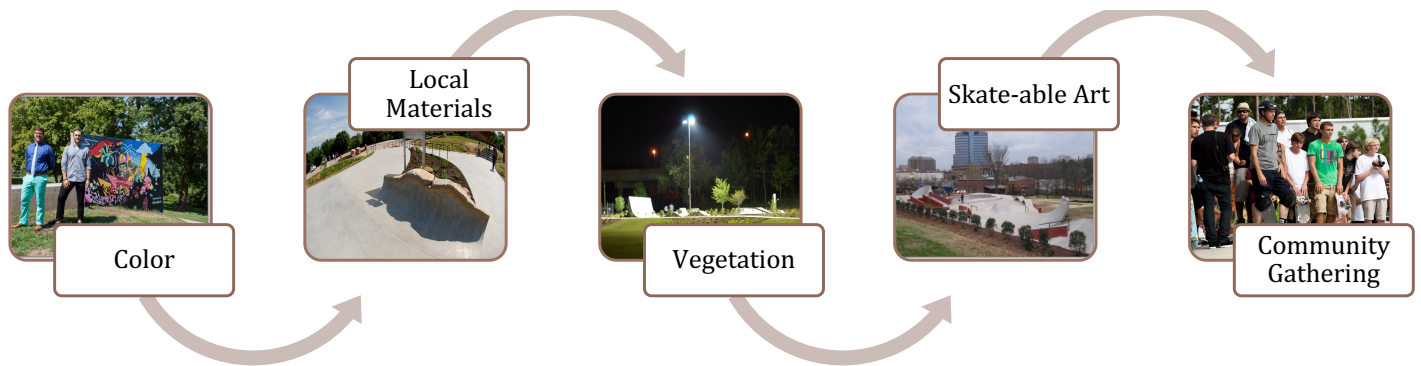

Our design team looks forward to working with your local users and community members. Skaters, by nature are artistic and creative individuals, we would like to tap into that and create skate-able architecture. Every community has that favorite spot the local users frequent. In order for skate-able architecture to be successful, designers must find ways to blend elements of public sculpture and site amenities into skate-able art elements. These artists structures provide stimulating works for art that can be admired by all community members. Our skate-able architecture elements are custom designed and ultimately tap into the local culture and history. Our dedication to creating unique spaces has proven helpful in fundraising and advocacy opportunities. Many of our facilities have raised funds using donor recognition from walk-able pathways, walls, benches to sculptures.

*A pole jam that mimics a historic canon*



*A mural that offers a changing canvas for local artists.*



*Recognition entry way*

# SUSTAINABLE DESIGNS

Since Pillar began, we have been committed to GREEN design and construction practices and have successfully implemented environmentally friendly designs that reduce our carbon footprint. The integration of natural drainage systems, recycled materials, site-specific designs, and energy efficient services aid in our environmentally responsible sustainable design and construction services.

A few examples:

Raingardens: Raleigh, NC, Framingham, MA and Dubuque, IA

Recycled Materials: Scottsdale, AZ and Raleigh, NC

Developing on Difficult or Brownfield sites: San Antonio, TX, Atlantic Beach, NC & Bar Harbor, ME

Pearsall Park Skatepark is a great example of what can be done with a once unused plot of land. A former landfill and now recipient of the Texas Recreation and Parks Society, Parks Design Excellence award. The once unusable site has been transformed to a very desirable family and community meeting place. Pearsall Park is 505 acres, designed to offer a dynamic open space with fitness and recreational amenities. The Skatepark was designed to match the overall flow of the other park amenities – while considering the other Skateparks in the area and the needs of the local skaters. The final product is this 13,000 sq. ft. Skatepark, the largest skatepark in the City of San Antonio.

The park includes:

Two splash pads

Two basketball courts

Skatepark

Event Stage

Children's Playground

Park Restroom

Reinforced lawn area

Twenty picnic tables

Two shade canopies equipped with picnic tables

Two hundred and fifteen parking spaces

One 40'x80x event pavilion area





# COMMITMENT TO COMMUNICATION

We are here to cultivate and progress your local users ideas into a fully functioning one of a kind Skatepark. This is why each and every Pillar Skatepark is different and we believe the key to our success. We know public participation has taken place, we are happy to open up social media channels during our design process to ensure the new design is well perceived to the public.

## City Staff Roundtables

We will kick off the project with a roundtable discuss with City staff. At this time, we will discuss project milestones, schedule and objectives. Set the tone for the project and begin the necessary steps towards success. Meetings will be held throughout the life of the project to ensure all necessary team members are apprised of project details.

## Community Groups

An open line of communication with community members will ensure a well-rounded design that can be enjoyed by all, users and non-users alike. These meetings will identify important design criteria, regarding aesthetics, artistic elements and amenities, while circumventing any potential issues and or concerns. This group can include Business Owners, Community Members, Organizations, Artist, Advocates and Developers.

## Public Workshops and Focus Groups

By conducting Public Meetings, we are able to involve the local community in creating their very own Skatepark. We employ an interactive approach, where we provide visual aids to help illustrate the different types of Skateparks. We then break out into groups and have members participate with sketching, discussions and are able to draw on the local user's style, creativity, needs and wants.

## Virtual Activities

Facebook is a great media tool used by our design team, it allows community members and or users to discuss design content, upload requested elements, complete surveys and stay up to date on activities and deadlines. If a dedicated FB page has not been created for the Rochester Urban Skatepark project, Pillar is happy to use our FB page as the hub.

Twitter: Our Twitter account will provide updates on status of the project and keep users informed regarding project status, and upcoming meetings.

Instagram: We will use our Instagram page to only keep the local users apprised of the project but also to advertise and ensure the proper influencers are engaged. We will create a dedicated hashtag (#) for your project, which will be given out at the first public input meeting.

# COMMUNITY INVOLVEMENT

Active participation is the cornerstone to our Community Involvement process. Over the past twelve years we have refined and created a successful approach to allow users to freely speak their minds, while cultivating ideas and depicting the Skatepark design process. We have developed tools to aid in our process, such as design criteria sheet and Skatepark questionnaire. Your dedicated Project Manager and Lead Designer will not only provide the social media channels for the design team but also direct numbers and emails for users to use freely during the design stage. Every stage of the design process will be documented on social media, open to suggestions and comments.

As professional Landscape Architects and Engineers, we go beyond Skatepark design and discuss all aspects of the masterplan design, such as amenities (lighting, parking, access walkways), GREEN drainage, custom artistic elements, safety, landscaping, etc.

Everything discussed will be provided visually, to help steer a productive discussion and ensure all aspects are clear and understood. Color renderings, 3D graphics and animations will be provided.

User sketch session

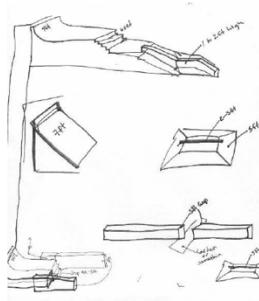



## IN-KIND DONATION ALLOCATION

We have an exceptional track record when it comes to cost estimating and value engineering. All design staff are educated on the proper construction techniques and standards as well as have hands on experience in Skatepark Construction. Before finalizing the final design, we make certain we will meet the project budget without any change orders. Our past experience not only provides examples of cost control, but we have also developed many programs that can dramatically reduce the overall construction cost and or add Skate-able square footage without any additional cost to for our Clients.

We use the given site to the project advantage, maximizing skate-able square footage and minimizing cost. For example, in Enfield, CT – the given site for the Green Manor Skatepark was located on an old handball court. Instead of demoing the concrete wall, we incorporated that element into the design. In Raleigh, NC – the Geo-Technical report showed copious amounts of granite throughout the site. Instead of removing the granite from site which would have been very costly, our team incorporate them into the final design –showing homage to the local area.

Our team has extensive experience in working with in-kind donations, we have completed over 22 Skateparks using our in-kind donation allocation program. We work with our clients, the local community and business owners and incorporate in-kind donations. These donations can be in the form of funds, services, materials or even discounts. We provide all the necessary information to our clients and aid them during this step of the project. Then after all in-kind donations are received we work that cost out of the total project budget. This enables our clients to get a larger park, incorporate materials, colors etc. that wouldn't have been possible with their original budget. We are happy to discuss in-kind donation allocation further, please feel free to reach out with any questions.

**Bar Harbor, ME    Size: 4,000 sq. ft.    Budget: \$65,000    Value: \$120,000**

MDI Skatepark, Bar Harbor, ME - Katie Churchill, Skate Committee

PJ 207.664.3016, [knc@myfairpoint.net](mailto:knc@myfairpoint.net)

**Saranac Lake, NY Size: 5,000 sq.ft.    Budget: \$200,000    Value: \$280,000**

Saranac Lake Skatepark, Saranac Lake, NC – Rich Shapiro, Skate Advocate

PJ 518.891.1869, [rich@gtgtandems.com](mailto:rich@gtgtandems.com)

**Roanoke Rapids, NC    Size: 8,000 sq.ft.    Budget: \$150,000    Value: \$320,000**

Roanoke Rapids Skatepark, Roanoke Rapids, NC - John Simeon, Director of Parks

PJ 252.533.2847, [jsimeon@roanokerapidsnc.com](mailto:jsimeon@roanokerapidsnc.com)

**Nashua, NH    Size: 20,000 sq. ft.    Budget: \$550,000    Value: \$880,000**

David W. Deane Skatepark, Nashua, NH - Thomas Galligani, Jr., Economic Development Director

PJ 603.589.3260, [galliganit@nashuanh.gov](mailto:galliganit@nashuanh.gov)



# SERVICES

Our team is fully capable and willing to meet all services listed within the RFP. We will walk the City through our typical design process, work with you to obtain necessary design approval and ensure qualified Skatepark bidders come to the table. Below is a brief summary of our design process for your review.

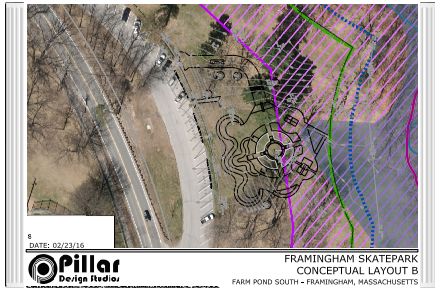

## 01 SKATEPARK PLANNING AND PROJECT MANAGEMENT

The goal of this phase is to perform an analysis of the identified site. Evaluate the location and condition, as well as identify and discuss existing design, program elements and create a design program for the overall phase that meets the intent of the project goals and objections. .



## 02 SCHEMATIC DESIGN AND PRELIMINARY ESTIMATE

The purpose of this phase is to create a fully functioning Skatepark – based on City rules and regulations, the Users and Community input while considering site limitations and or opportunities as well as the not to exceed budget. This phase can include; both public and private design review meetings, sample concept designs, final masterplan design with preliminary cost estimate as well as a 3D fly through video and in-kind donation allocation.

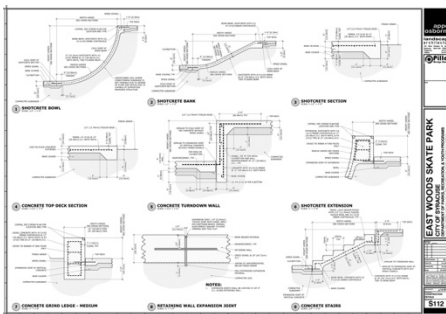

## 03 DESIGN DEVELOPMENT

Design Development expands upon the masterplan design providing detailed direction as to the materials section, location, Skatepark terrain layout/dimensions and site amenities, if applicable. This includes private meetings with City as well as a refined cost estimate.

## 04 CONSTRUCTION DOCUMENTS

Upon approval Pillar will finalize the construction documents in technical detail, setting forth the requirements for construction. Submittals will include 90% and 100%. Final drawings will be sealed by a licensed Professional Engineer and meet all local, State and Federal requirements. We are knowledgeable of ACI, STM and CSI formats. As well as follow ASTM: F2334 and F2480 standards.



## 05 POST DESIGN SERVICES: BIDDING AND CONSTRUCTION ADMINISTRATION

To bring qualified bidders to the table, ensuring all technical aspects of the bid and or design are answered fully. To conduct on-site visits to ensure the Skatepark is being completed on-time, within budget and per planned.



Our design team will work the City providing insight and recommendations when it comes to long-term viability, maintenance, skate-ability, location, integration, visibility, aesthetics, etc. We are capable and able to meet any deadline set forth by the City. **We design destination facilities, recreation spaces for all community members to enjoy, that encompasses all levels of users - the final product is a park you can Skate.**

## Sample of Construction Drawings:

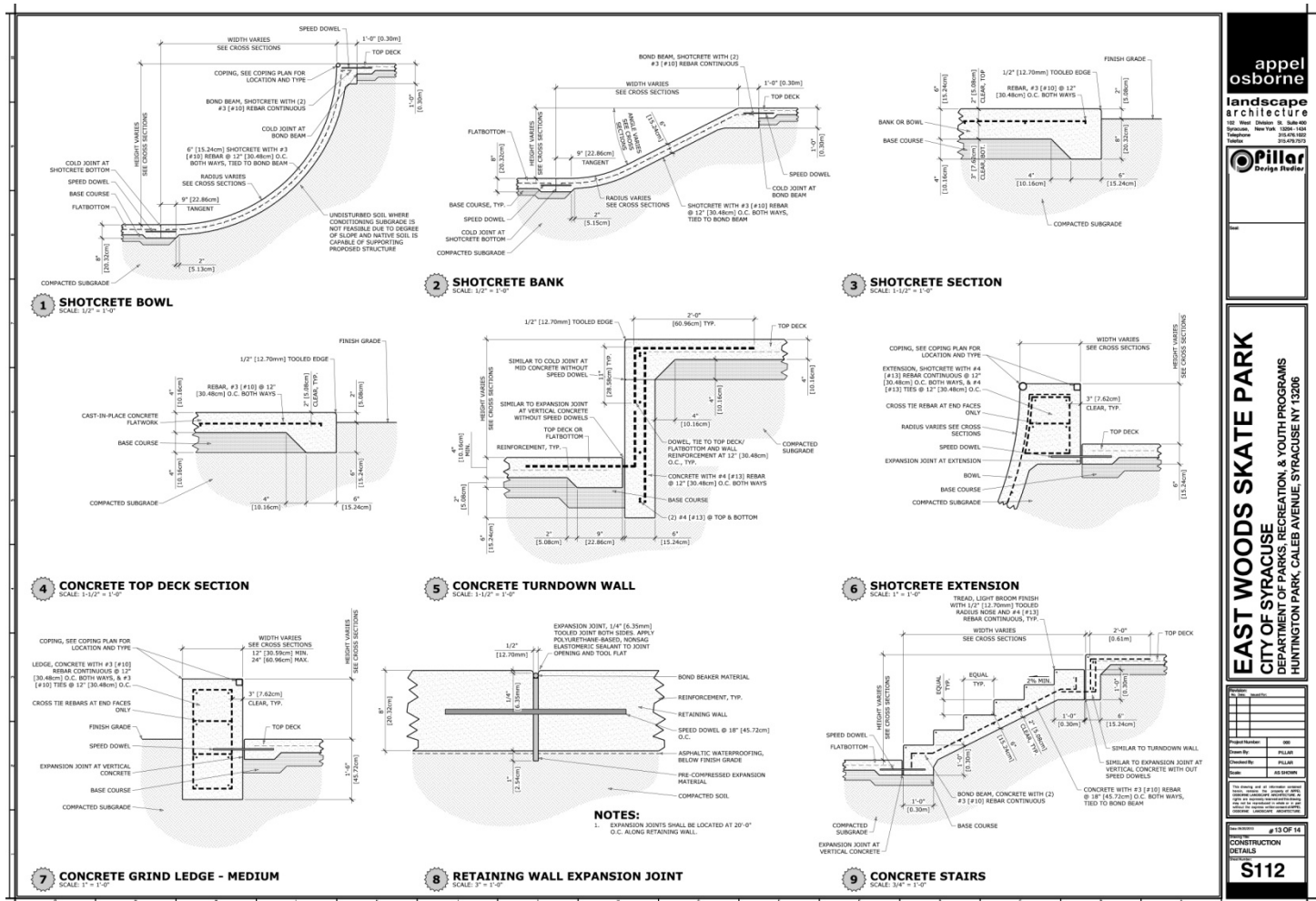

We have successfully completed Skatepark projects throughout the United States and the World, including Vicksburg, MS, Lincoln and Imperial, NE, Pleasanton and San Antonio, TX and are capable and able to meet all local, State and Federal regulations.

# TEAM STATISTICS



**12**

Years of  
achievements



**300**

Successful  
projects



**35**

Funding Assistance  
Grant Awards



**6**

Design Awards

Skateboard lovers are raving about the city's new skateboard park, which is being praised as **one of the best skating facilities in New England.**

Now we have a new park that rivals any on the East Coast, adding she hopes it will provide a gateway for many to achieve new skills.

Lisa Fautex, Director of Public Works – Nashua, NH  
Quoted by Union Leader – New Hampshire News  
David W. Deane Skatepark located in Nashua, NH

## It's great! It's really amazing.

It's so expansive and offers something for all skill levels. It caters to every skill level and is a great addition to this area.

**Tony Hawk, Professional Skateboarder**  
Historic Fourth Ward Skatepark  
located in Atlanta, GA  
Tony Hawk's Foundation  
awarded the project \$25,000

The park still looks GREAT! Pillar was designed the Skatepark April of 2011 and completed the build by August 2011. The build was completed on time and under budget with no workmanship or structural issues of any kind and no failures to date. The park still looks as good as new.

With the addition of the Skatepark our **usage has dramatically increased** and has attracted skaters from outside the county.

Steve Lackey, Assistant Director  
Lakeside Skatepark located in Kissimmee, FL



## BRAD SIEDLECKI, PRINCIPAL-IN-CHARGE, SKATEPARK DEVELOPMENT



Mr. Siedlecki has been a professional in the Skatepark design and construction industry since 2001, serving many different roles from Project Management, Planning, Design, Construction Documentation to Construction. Brad's passion for Skateboarding began at an early age where he could be found building ramps or Skating the streets of central New York, but it was not until attending college at Arizona State University did his dream become a reality. While pursuing his Bachelor's Degree in Landscape Architecture Brad continually pushed the envelope to look beyond the typical park planning format and introduce a non-traditional approach when developing park systems.

Over the past decade, not only has Mr. Siedlecki created industry standards in Construction Documentation, specifications and details but he continues to be involved during the construction of the project – gaining invaluable experience of working in the field.

### CREDENTIALS

Skatepark Design and Construction, AutoCad, SketchUp, Feasibility, Site Selection and Analysis, Stormwater Management, GREEN and ADA Specialist, Cost Estimation and Scheduling, Value Engineering, In-Kind Donation Allocation, Public Facilitation  
Guest Speaker at ASU for Parks and Recreation and Senior Landscape Architecture Classes  
Educational Sessions at NRPA on Action Sports Facilities  
OSHA, ASTM, World of Concrete Proficient  
Bachelor of Science in Landscape Architecture

### RELEVANT PROJECTS – Mr. Siedlecki served as Project Manager and Lead Designer

Framingham, MA – Site Analysis and Selection, Schematic Design, Design Development, Construction Documentation, Bidding, Construction Administration and Grand Opening Festivities. This included numerous site visits, as well as determination of the park placement, public input meetings and stakeholder meetings. Due to the site being located in a 100 year floodplain. Brad worked with a local Civil Engineer to upgrade the existing drainage system and included a raingarden. 10,000 sq. ft. Completed: 2018

Nashua, NH - Schematic Design, Design Development, Construction Documentation. This was a unique design process as **Brad was given a list of elements and type of terrain that was required to be included in the design while fitting within the site footprint given and the allotted budget.** He also worked extensively with the City to aid in funding allocation – assisting with acquiring in-kind donations and working them back into the construction budget. This resulted in a \$330,000 savings. 20,000 sq. ft. Completed in 2017

Scottsdale, AZ – Brad worked with multi-disciplines on this \$15,000,000 recreational complex. Working alongside the LA to ensure the Skatepark fit into the overall design and flow of the other amenities, Mr. Siedlecki conducted public input meetings and designed a Skatepark that reflected the local area and history of the tribal community. This urban plaza includes color concrete, native plants and mimics the SRP Indian Tribes great seal. The bidding process was successful with numerous bids all under the estimated budget. Mr. Siedlecki handled schematic design, including public input, design development,

construction documentation, bidding, construction administration and grand opening festivities. 16,000 sq. ft. Completed 2018

Rodanthe, NC – A unique project due to the site location and obstacles, not only was there a historic landmark that could not be disturbed but also a high-water table that needed to be addressed. In order to expedite construction and lower construction cost – Mr. Siedlecki specified an alternative fill material. EFP foam was used to reduce weight as well as keep construction cost low without compromising on quality and or creativity of design. The final design included a large vertical flat wall that faces the community open space, this portion of the Skatepark doubles as a movie screen, for skate videos and community movies. Services included schematic design, including public input, design development, construction documentation and construction administration services. 7,000 sq. ft. Completed in 2017

Greensboro, NC – Greensboro included a large regional facility as well as a small skate spot. Latham Park (regional facility) was a perfect location due to the greenway connectivity throughout the park, linking the Skatepark to other amenities and giving skaters a way to safely get to the park with their boards. The site was also home to a 200 year old historic Oak tree, in order to preserve the critical root zone of the tree, Brad designed the Skatepark in two separate sections using a skate-able sidewalk to connect them. Comprehensive design workshops as well as social media outreach shaped the final design, which consist of a flow bowl section and street flow with street elements incorporated into the connection sidewalk. After completion two local artists were selected to create a mural on the back of the vert wall. Services included schematic design, including public input, design development, construction documentation and construction administration services. 10,000 sq. ft. Completed in 2017

San Antonio, TX – The Pearsall Park Skatepark was one component in a large 505 acre masterplan project. We worked directly with the City, local Landscape Architect, Engineer and Construction Company. Mr. Siedlecki conducted numerous public input meetings as well as in depth design and engineering to ensure this brownfield site was transformed to an ideal facility for health, wellness and outdoor family gatherings. **Successfully put out to bid with numerous qualified responses.** Services included schematic design, design development, construction documentation, bidding and construction administration services. 13,000 sq. ft. Completed in 2016

Colombia County, GA – Action Sports Facility – Blanchard Woods project included a regional Skate facility as well as a competition style Bike park. After an in-depth public input process, the final design is an authentic street style park, equipped with everything you would find in the actual streets. The park is designed for all skill levels and includes a flow bowl with both steel and pool coping. **The project was successfully put out to bid with numerous qualified responses.** Services included schematic design, design development, construction documentation, bidding and construction administration services. 9,000 sq. ft. Completed in 2015

Baltimore, MD – Designed in phase the Skatepark of Baltimore began as a grassroot effort whose mission is to facilitate the construction of a public, custom, concrete destination Skatepark. Phase One included a concrete bowl and was completed in 2014 and Phase Two completed in 2016 included stairs, handrails and ledges to compliment. Services included schematic design, public input, design development and construction documentation. 14,000 sq. ft. Completed in 2016

Nynashamn, Sweden – Brad received in-depth detail when it came to the design of Nynashaman Skatepark. The local skaters requested a symmetrical design, so that no matter if you were regular or goofy footed you could skate the park in either direction. The end result is a bowl and street track, the project also included entrance walkway, lighting and landscaping around the park. Services included schematic design, public input, design development, construction documentation and construction administration. 10,000 sq. ft. Completed in 2014 **A more in-depth list can be provided upon request.**



## **BARRETT CROOK, PROFESIONAL ENGINEER AND LEEDP AP**

Mr. Crook is the newest member of the Pillar team, joining in 2013. He was an easy fit as he not only possesses a Bachelor's Degree in Civil Engineering; he has over 20 years' experience leading Structural Engineering efforts. A perfect addition for specialty structures such as Skateparks – this allows our team to handle all efforts of the Skatepark design (from the deck in) in house.



Mr. Crook has more than 20 years of structural engineering experience which involves water, wastewater, and reclaimed water collection, distribution, storage, and treatment elements. He has been actively involved in the treatment upgrades at water reclamation (advanced wastewater treatment) facilities. This work included planning, design, CM, and start-up of odor control, storage and pumping systems, headworks facilities, and liquid and solids process trains. He will work with the Design team handling drainage, structural needs as well as stamp the final drawings.

### **CREDENTIALS**

Stormwater Management, Structural Calculations, GREEN Drainage Design. Registered PE in 23 states. Member of American Society of Civil Engineer, American Concrete Institute, United States Green Building Council & LEED Accredited Professional.

Bachelor of Science in Civil Engineering

**Mississippi, PE License # 18348**

### **RELEVANT PROJECT EXPERIENCE**

Salisbury, MD – Barrett completed an in-depth stormwater management plan for the masterplan of the Salisbury Skatepark. Designed in three phases, it was essential to have a true cost estimate and complete masterplan design in the first phase. 13,000 sq. ft. – Phase I Completed 2015, Phase II Completed 2017

Imperial, NE – Barrett served as Technical Advisor and registered Professional Engineer – ultimately reviewing and sealing the final drawings. This was a community effort, as a group of young boys decided they needed a Skatepark and went to their Village and requested one. Impressed with this group of individuals the Village allocated \$100,000 towards the Skatepark, the young skaters raised another \$70,000. 5,000 sq. ft. Completed in 2018

Bar Harbor, ME – Located on an island off the coast of Maine and surrounded by the Acadia Nation Park, the Bar Harbor site is nothing but idyllic. The location while offering such amazing views also provided many restrictions when it came to both design and construction of the park. Mr. Crook ensured structural safety while serving as technical advisor and Engineer of record for the project. 4,000 sq. ft. Completed in 2017

Enfield, CT – The City had an old above ground steel Skatepark that was fall apart and the yearly maintenance cost was becoming exuberant, so they hired our design team to come in and design a new custom concrete Skatepark within a very tight budget of \$99,000. The old asphalt pad the old Skatepark happened to be on was also home to a handball court. When the City removed the asphalt pad, we asked for the handball court to remain. We incorporated this into our design, providing a unique element that was cost effective. Mr. Crook ensured structural safety while serving as technical advisor and Engineer of record for the project. 2,500 sq. ft. Completed in 2017

## **BRADLEY BARTELL, SENIOR LANDSCAPE ARCHITECT & QUALITY CONTROL**



A University of Georgia graduate with a degree in Landscape Architecture, and registered Landscape Architect since 1990, Brad Bartell brings his large facilities master planning expertise to Pillar Design Studios. Brad's skilled approach to design is the result of his 25-plus years' experience in design, landscape design, land planning, project development, and construction management throughout the United States, Europe, the Middle East, and South Africa.

Bradley is also a member of Council Landscape Architectural Registration Board; this allows us to easily and quickly obtain a Landscape Architect license in any state throughout the United States. Bradley has served as the Lead Landscape Architect handling Quality Control and sealing of all necessary drawings since 2006.

### **QUALIFICATIONS**

Licensed Landscape Architect in 5 States.

ASLA, NRPA, CLARB certified since 2004, OSHA

Bachelor of Landscape Architecture

### **RELEVANT PROJECT EXPERIENCE**

Atlantic Beach, NC – The design process was even more of importance to the success of this Skatepark due to the proximity of the Atlantic Ocean and the soil conditions. After listening to the public and gathering necessary site information the design team created a Skatepark for all skill levels and user groups. Build upon a sand dune and at sea level, everything was built above ground. Mr. Bartell served as Senior Landscape Architect working directly with the Project Manager and Lead Designer during the design phase, as well as reviewing and stamping the final drawings. 13,000 sq. ft. Completed in 2016

Waynesville, NC – A unique project, as the original design team was let go due to non-performance and unable to meet budgetary and scheduling requirements. Due to this the shape of the Skatepark had already been decided on at previous public input meetings. Our design team worked together to improve the flow of the park and enhanced the skate-able elements without making vast changes to the park layout. Bartell collaborated with the Town's horticulturalist to select specimen trees that are native to western North Carolina, represent the best performers in the region, and to add trees to the town's inventory that were not as prevalent. He stretched the budget to balance the hardscape with a beautiful and abundant landscape which also included several tons of boulders that were hand selected and transported from the town's landfill. The park also includes a pedestrian plaza with a special area to display donor recognition bricks, a connection to the local greenway and adjacent dog park, and relocation of two tees as the park was designed in the fly zone of two disc golf holes. 10,000 sq. ft. Completed in 2013

Monte Vista, CO – Brad's masterplanning experience was a great benefit to completing this project on time and within budget. The project included design, construction, stormwater management, restrooms, lighting, fencing and spectator viewing areas. When designing the Montez Skatepark, we felt it was important to have a park like feel, providing a place for every family member not just the users. Mr. Bartell served as Senior Landscape Architect working directly with the Project Manager and Lead Designer during the design phase, as well as reviewing and stamping the final drawings. 12,000 sq. ft. Completed in 2012



## **SCOTT MATTHEWS, PRODUCTION MANAGER**

Scott Matthews brings 13 years of Drafting and Design experience to Pillar. Scott's multidisciplinary background allows Pillar to effectively coordinate with all members of the design team. Along with the creation of construction documentation, cost estimates, preparing bids and written specifications for over 100 public and private Skate Parks.

Scott also has experience with 3D graphics, as well as landscape, hardscape, irrigation, and grading design. Scott enjoys taking the ideas, concepts and drawings and creating 3D graphics, all can enjoy and understand. As a recreational Skateboarder, Scott understands the nuances a Skate Park design entails and is able to relay, massage and convey the designer's ideas. Scott has been assisting with all production materials including but not limited to 3D graphics, Construction Documentation and Cost Estimating at Pillar Design Studios since 2006.



## **CREDENTIALS**

Advanced knowledge of AutoCAD, AutoLisp, Office, Visual Basic and SketchUp Extensive knowledge in Landscape Architecture, Structural and Drainage systems Associates Degree of High Tech Institute, Phoenix, Arizona Continuing Education: Technical Associates Degree in Electro/Mechanical drafting/CAD

## **RELEVANT PROJECT EXPERIENCE**

Turner Falls, MA – The Skate committee raised more than \$60,000 through raffles, poetry, readings, can and bottle drives, benefit concerts and skateboard art auctions. Scotts was able to provide a detailed cost estimate to both the City as well as the Skate committee to aid in fundraising efforts and help securing the final funding needed for construction. 7,500 sq. ft. Completed in 2015

Saranac Lake, NY – Another Skate Committee dedicated to establishing a concrete Skatepark in their hometown. Saranac Lake donated a 5,000 sq. ft. piece of land to the Skate Committee but the task of raising funds was on them. Working directly with our Lead Designer, Scott assisted with in-kind donations and cost estimating. The end results were a \$70,000 savings for the Skate Committee. 5,000 sq. ft. Completed in 2015

Buxton, NC – The site for the Buxton Skatepark is only ¼ miles from the Atlantic Ocean in the Outer Banks of North Carolina. The lack of stormwater drainage options and high water table meant the 6,000 sq2. Ft. flow bowl would need to be built entirely above ground. Scott prepared the cost estimate and assisted with construction documentation. 6.000 sq. ft. Completed in 2017

Annapolis, MD – The Truxton Skatepark was completed through donations and in-kind services. Working with Kip Moore and his Comeback Kid Charity, our team transformed this old above ground Skatepark. Scott worked directly with the Lead Designer to ensure an accurate cost estimate was created, due to the significant amount of in-kind being provided this step was crucial to the success of the project. Scott served as Production and Technical Assistance. 7,000 sq. ft. Completed in 2016

## **NICOLE LICARI ROBERTSON, BUSINESS DEVELOPMENT AND FINANCE**

Nicole brings over 17 years of bookkeeping, human resources and office management experience to Pillar.



Her work experience within the action sports and landscape architecture industries is an asset not only to Pillar but also our clients. Nicole brings her knowledge of the industry, the process, and its trends to the firm, enabling her to better assist clients in selecting the best park to suit their Community's needs.

Nicole has been an integral part of the Pillar organization since conception; and has been working in the Skate industry since 2004. She has developed countless materials to aid in the Skatepark process, delivering a detailed manual of how to for Skaters interested in having a Skatepark in their local community.

She is skilled in grant submissions, funding opportunities and grassroots efforts. She has helped over 20 communities qualify and receive the Tony Hawk Foundation grant as well as many local, State and Federal Grants.

Nicole will handle all Administrative duties including but not limited to Billing, Insurance Requirements, Travel Arrangements and Social Media updates.

### **CREDENTIALS**

Skatepark Advocate, Fundraising, Grant Submissions, Government Contracting, Marketing, Insurance, Human Resources, Payroll, Accounting

Bachelor of Science in Technical Management, Associates Degree in Business Administration

Hanover, IL – Nicole's first conversation with Hanover was discussing the benefits of a concrete Skatepark. Hanover had a small budget of \$65,000 and was just about to move forward on a modular above ground Skatepark. After working with Nicole and discussing their options, they were able to receive 3,500 sq. ft. concrete facility. 3,500 sq. ft. Completed in 2015

Dubuque, IA – The City of Dubuque earmarked \$600,000 towards a new Skatepark with the assumption that the Skate committee must raise the additional \$250,000. Nicole worked hand in hand with the Skate committee assisting with funding materials, providing information for grant opportunities and using social media to help the cause. Construction is currently under way on and set for completion October 2018.

Imperial, NE – When Nicole first spoke to the City of Imperial regarding their Skatepark project, she was told they were moving forward with an above ground park because that is all they could afford. Nicole assured them that is just not the case, began discussing cost savings methods and possible funding opportunities. Less than nine months later, they had been awarded a Tony Hawk Foundation Grant and had received a \$200,000 Skatepark for \$150,000. Nicole served as Funding Advocate and aided in the pre-planning stages. 5,000 sq. ft. Completed in 2018

Salisbury, MD – Salisbury was on a quest to create a destination Skatepark. We were contacted by Deborah Stam, Assistant Director of Housing & Community Development to aid in this pre-planning stage. Nicole worked with Deborah, laying out next steps and best practices. Two date they have received two DNR grants and one Tony Hawk Foundation Grant. Phase I and II has been complete and Phase III is in the fundraising stage. 13,000 sq. ft. Completed Phase I 2015, Phase II 2017



## RELEVANT PROJECT EXAMPLES

### SARANAC LAKE SKATEPARK

The Saranac Lake Community had been fundraising for over 11 years before they were able to see the fruits of their labor. Another Pillar project that received a Tony Hawk Foundation grant and this one being the largest of 11 grants given out that year by the Tony Hawk Foundation.

This 5,000 sq. ft. Skatepark has a little something for everyone; the community members gave input and helped shaped the final design of the Skatepark. The Skatepark has been the most used park facility in the Village. After seeing the amount of use the park received, the Village decided to install lighting to lengthen the park availability to users.

Project Name:	Saranac Lake Skatepark	Project Owner:	Town of Saranac Lake
Project Size:	5,000 sq. ft.	Estimated Budget:	\$200,000
		Actual Budget:	\$143,000 + In-kind





## HERMOSO SKATE PLAZA PROJECT

The City of Phoenix knew they were spending too much money maintaining an old above ground Skatepark and wanted to create a new Skatepark that would better fit into the overall vision of the Hermoso Park. Our design team was hired as Skatepark Specialist to ensure the new Skatepark would not only seamlessly fit within the new vision of the surrounding areas but also be designed for longevity and low maintenance.

After public input sessions, we incorporated the local skateboarders and community members request and created a multi-use street park that ties into the new community center. This 6,000 sq. ft. plaza consist of quarter pipes, multiple ledges, a “whale tail”, stairs and more. It is a perfect addition to the neighborhood and doubles as a new venue for community events, such as farmers market.

Project Name: Hermoso Skatepark  
Project Size: 6,000 sq.ft.  
Actual Budget: \$200,000

Project Owner: City of Phoenix  
Estimated Budget: \$200,000





## RODANTHE SKATEPARK

The Rodanthe Skatepark was a unique project due to the site location and obstacles. The end result is a 7,500 sq. ft. Skatepark built entirely above ground. This park includes unique design feature and a historic landmark.

The entire Skatepark was designed around an historic landmark, a gravestone from the 1800's. The client also requested to incorporate a large vertical flat wall that faced their community open space, this portion of the Skatepark doubles as a movie screen, for skate videos and movies can be played for the community.

Due to the high-water table issues and as well as necessary soil remediation our team offered an alternative fill material. EPS foam was used to reduce weight, lower construction cost and expedite the construction process without comprising on quality and or creativity of design and flow. Please note the budget of \$300,000 did not include soil remediation.

Project Owner:	RWS Community Center	Estimated Budget:	\$300,000
Project Size:	7,500 sq.ft.	Actual Budget:	\$300,000

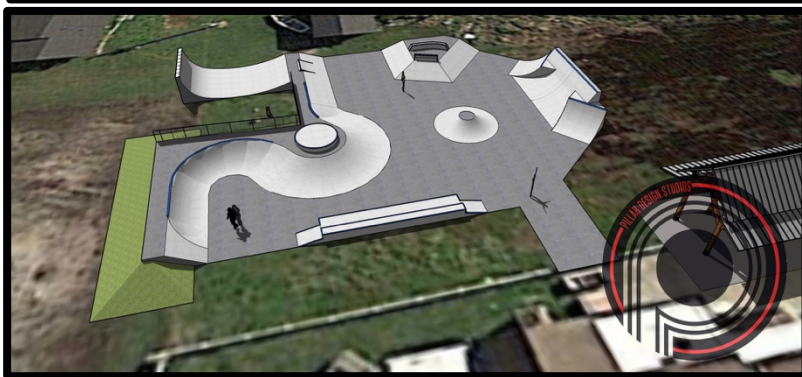

## TIERRA SKATE PARK PROJECT

The City of Lincoln had an old dilapidated above ground Skatepark that was placed on an existing concrete slab. The yearly maintenance costs were continuing to increase and they City knew it was time to do something about it. Our Design team was hired to discuss the current Skatepark and make recommendations regarding renovations and upgrades.

After reviewing the site and the current Skatepark, we put together a plan that not only provided a quality, concrete Skatepark but it increased use and drastically reduced the yearly maintenance cost.

Tierra Skatepark is a perfect example of how our team works with the site given, to minimize cost and maximize size. By using the existing pad as our foundation, we were able to provide an 8,000 sq. ft. Skatepark for \$125,000. The final Skatepark was completed for \$15.60 a sq. ft., which is \$24.40 under the national average.

Project Location: Lincoln, NE  
Project Size: 8,000 sq.ft.

Project Owner: City of Lincoln  
Estimated Budget: \$125,000  
Actual Budget: \$125,000





## ROANOKE RAPIDS SKATEPARK

The Roanoke Rapids Skatepark was truly a community effort. The City knew they had a need for a quality Skatepark but funding was an issue. Working within a fixed budget of \$150,000 our team discussed possible in-kind donation allocation, so that we could meet the request of the users and create a larger facility. The City provided countless hours of labor during construction, including but not limited to rough/fine grading, all import fill materials, placement & compaction of said materials, storm drain materials as well as installation and housing during construction. The result was a Skatepark completed for \$18.75 a square foot, instead of the national average which is \$40 – 45 a square foot. That is a value of \$170,000.

Project Size:	8,000 sq. ft.	Estimated Budget:	\$300,000
		Actual Budget:	\$150,000



## VANCE STREET SKATEPARK

Our team was sought out by the Prime Engineer for this project after the original designer was let go due to poor performance and **not being able to meet budgetary and scheduling requirements**. Pillar significantly improved the “flow” of the park and enhanced the skate-able elements without making vast changes to the park layout, as it had been vetted through the local stakeholder and public involvement process.

Our team collaborated with the Town’s horticulturalist to select specimen trees that are native to western NC, represent the best performers in the region, and to add trees to the town’s inventory that were not as prevalent. We stretched the budget to balance the hardscape with a beautiful and abundant landscape which also included several tons of boulders that were hand selected and transported from the town’s landfill.

Project Location:	Waynesville, NC
Project Size:	10,000 sq. ft.
Skatepark Budget:	\$300,000

This 10,000 sq. ft. park encompasses a street orientated design with numerous obstacles to increase the flow and overall connectivity. Everything is designed with the idea of not having to push but allowing the velocity of the features to propel you throughout the park. The park also includes a pedestrian plaza with a special area to display donor recognition bricks, a connection to the local greenway and adjacent dog park, and relocation of two tees as the park was designed in the fly zone of two disc golf holes.





## DUBUQUE SKATEPARK

The Dubuque Skatepark project began as Feasibility and Site Selection. The City was aware of the need for a new concrete Skatepark but unsure of the best location and size. Pillar was awarded this initial planning stage not only due to our team's background in Skatepark masterplanning and site selection but also our in-depth planning process. We have extensive experience in assisting municipalities with the best approach to ensure a cohesive plan and process. After reviewing five potential locations, conducting numerous public input meetings, online surveys and design collaboration with the local skate committee. Flora Park was set to be home to the new Dubuque Skatepark. Our design team, completed a comprehensive construction documentation package, which included lighting, storm watermanagement, ADA access and shade structures.

The City promised \$600,000 towards the Skatepark but the community of Dubuque, wanted a regional facility that would draw users from all over. So, the Skate Committee set and raised the additional \$250,000 needed to complete their goal. Our design team assisted with Grant submissions and provided assistance and direction with funding opportunities. **We worked with the City during the bidding process, ensuring qualified bidders were engaged and all questions, clarifications had been made.** Please note the budget includes ADA sidewalk, GREEN drainage system, shade structures as well as season ting areas.

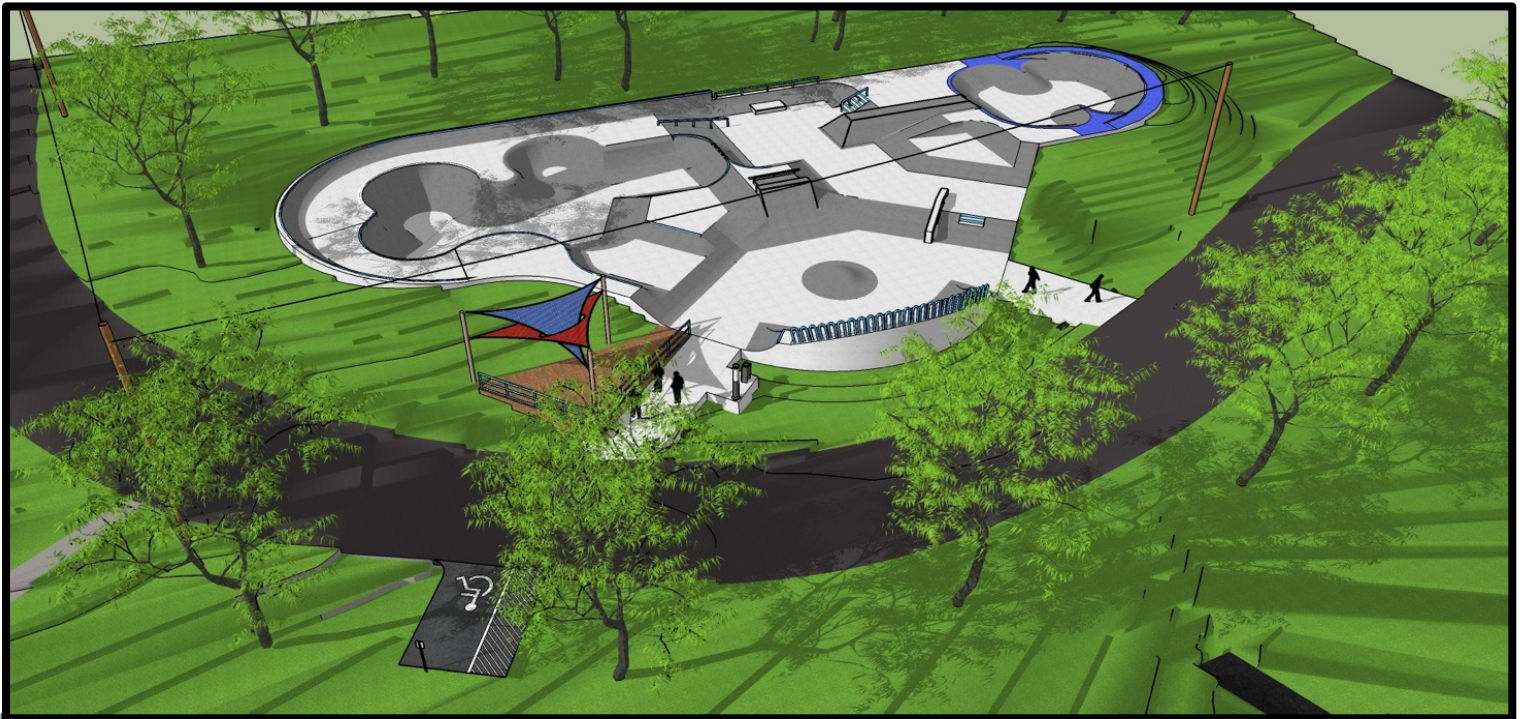

Project Contact:  
Steve Fehsal  
Park Division Manager  
563-589-4260  
Sfehsal@cityofdubuque.org

Project Size: 12,000 sq. ft.  
Project Budget: \$850,000

You can see a fly through video of the Dubuque Skatepark Concept at  
<https://youtu.be/ZUIWLaIHS6U>





Public Input Meeting – Social Media will increase your turn out.

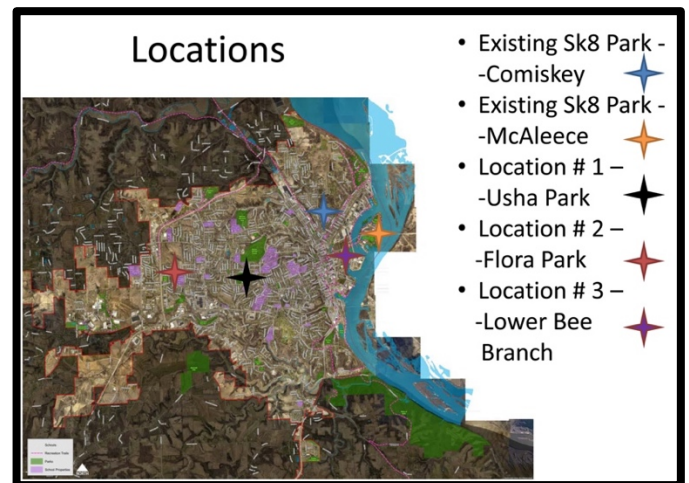

The Skatepark is currently under construction and set to be completed by the end of the month. To date we are on time and within budget, with no change orders. You can see a construction video from start to now at <https://bit.ly/2Qt2Z2Y>.







## REFERENCES

Saranac Lake Skatepark, Saranac Lake, NC  
Rich Shapiro, Skate Advocate, Gear- to -Go Tandems  
P] 518.891.1869, [rich@gtgtandems.com](mailto:rich@gtgtandems.com)

RWS Skatepark, Rodanthe, NC  
Joe Kierzkowski, Board Chairman  
Rodanthe Community Center  
P] 520.559.4352, [bluewhalesalvo@gmail.com](mailto:bluewhalesalvo@gmail.com)

Roanoke Rapids Skatepark, Roanoke Rapids, NC  
John Simeon, Director of Parks  
P] 252.533.2847, [jsimeon@roanokerapidsnc.com](mailto:jsimeon@roanokerapidsnc.com)

John Jenkins, RLA, Principal In Charge  
Stewart Engineering, Inc.  
P] 919.719.1045  
[jjenkins@stewarinc.com](mailto:jjenkins@stewarinc.com)

Hermoso Skatepark, Phoenix, AZ  
Shari Zimmerman, RLA – Project Prime  
GBtwo Landscape Architecture Inc.  
P] 480.991.3384, [shariz@gbtwo.com](mailto:shariz@gbtwo.com)

Tierra Skatepark, Lincoln, NE  
JJ Yost, Facilities Manager, Parks and  
Recreation - City of Lincoln  
P] 402.441.8255, [jjost@lincoln.ne.gov](mailto:jjost@lincoln.ne.gov)

Dubuque Skatepark, Dubuque, IA  
Stephen Fehsal, Parks Division Manager  
P] 563.589.4263, [sfehosal@cityofdubuque.org](mailto:sfehosal@cityofdubuque.org)



# The Skate Park Association International

501 c3 non profit

## 2018



## Recognition for Skate Park Design

*presented to*

**Pillar Design Studios**



*by*



8/11/18  
date

  
executive director  
heidi lemmon



## CONSTRUCTION EXPERIENCE

We offer irreplaceable field experience when it comes to construction, your dedicated project manager has over a decade of construction administration services experience. He has worked in the field on over 100 Skatepark projects from site preparation and layout to formwork and finish – he understands the nuances of Skatepark construction and is able to convey true and accurate drawings and plans to aid in efficiency and accuracy during the construction process. He continues to work in the field each year, as he believes in order to be the best designer possible, you must understand every aspects of the project and be able to build what has been designed.

We truly provide a unique prospective as we are the **ONLY** Skatepark design firm that is Skater owned and operated. We have cultivated a team of professionals, industry leaders and advocates while maintaining our sole purpose of creating, custom, world class – destination Skateparks. Since the creation of Pillar, we have been aiding municipalities, guiding them through the design and construction process. We have worked with all the leading names in Skatepark construction and are able to bring multiple bids to the table. Our extensive experience working with Skatepark construction companies over the past decade allows us the advantage of understanding skill levels, variances and cost. Our team will bring the right builder for your park, each Skatepark builder offers a different style of construction – our job is to aid in the process and help find the perfect fit for your design and ultimately Skatepark.

We deliver hands on experience, your dedicated Project Manager is the Owner of our firm, he is your main point of contact and will remain so, throughout the life of the project. The team members listed will work on your project, we never duplicate designs and continue to stay on the leading edge of Skatepark design and techniques. We welcome any questions regarding our experience and or response. We look forward to working with you in the future. Thank you for your time and consideration.

### THE PILLAR TEAM

